



# Start Here

## Quick Start Guide

### WARNING

- This Quick Start Guide does not replace the User's Manual for your Accu-Chek Guide blood glucose meter. The User's Manual contains important handling instructions and additional information.
- The lancing device is intended for personal use only.

### Overview



- 1 Display
- 2 Back Button
- 3 Up Arrow and Down Arrow Buttons
- 4 Power/Set/OK Button
- 5 Test Strip Slot with Light
- 6 Battery Door
- 7 Micro USB Port
- 8 Test Strip Ejector

### Set Language and Time Format



Turn the meter on by briefly pressing **OK**. **Language** appears. Press **Up** or **Down** to highlight the desired language. Press **OK**.

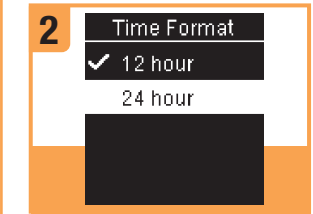

**Time Format** appears. Press **Up** or **Down** to highlight **12 hour** (am/pm) or **24 hour**. Press **OK** to set the option and return to **Main Menu**.

### Set up the Lancing Device

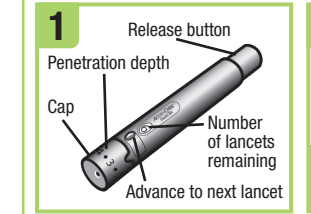

Familiarise yourself with the Accu-Chek FastClix lancing device.

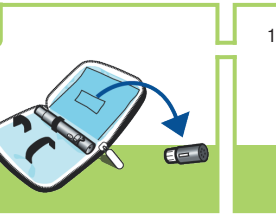

Get the lancet drum from the pocket in the carry case.

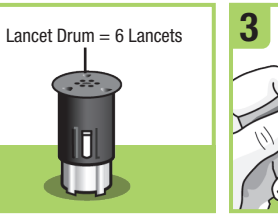

**NOTE**  
Each lancet drum contains 6 sterile lancets.

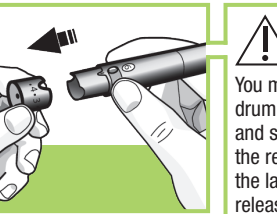

Remove the cap by pulling it straight off. Do not twist the cap.

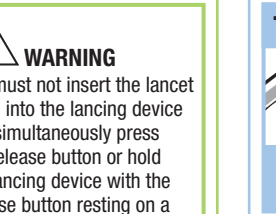

**WARNING**  
You must not insert the lancet drum into the lancing device and simultaneously press the release button or hold the lancing device with the release button resting on a surface such as a table top. This could release a lancet and inadvertently cause injury.

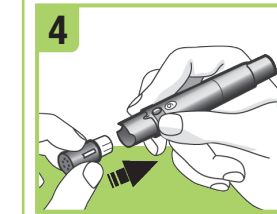

Insert the lancet drum, white end first, into the lancing device. Push the drum all the way in until it clicks firmly into place.

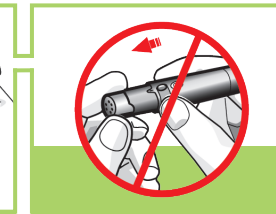

**NOTE**  
Do not remove the lancet drum until all 6 lancets are used since the drum cannot be reused once it has been removed from the lancing device.

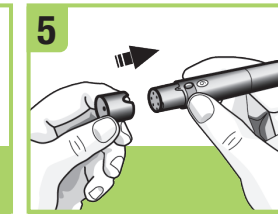

Replace the cap on the lancing device. Make sure the notch on the cap lines up with the notch on the lancing device.

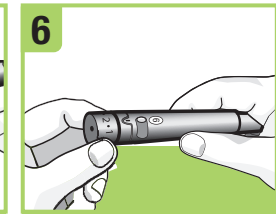

Adjust the lancet depth to a comfortable penetration level. Start at 2. For tougher skin, dial to a higher number.



Using the lancing device: By pressing the release button, the lancing device primes and pricks with 1 click.

### Perform a Blood Glucose Test

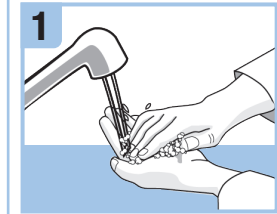

Wash and dry your hands before you perform a blood glucose test.



Check the use by date on the test strip container. Do not use test strips past the use by date.



Remove a test strip from the test strip container. Close the cap tightly.

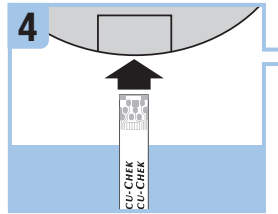

Insert the metallic end of the test strip into the meter.

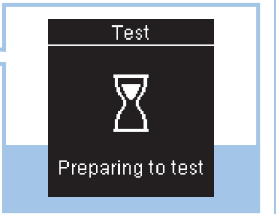

The meter turns on. **Preparing to test** appears.

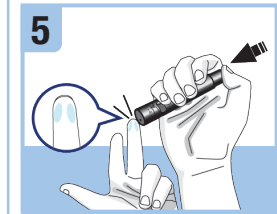

Press the lancing device firmly against the side of your fingertip and press the release button to prick your finger.

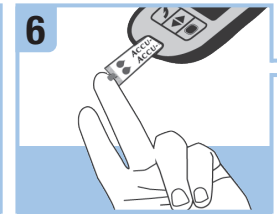

Touch the **yellow edge** of the test strip to the blood drop. Remove your finger from the test strip when **Analyzing** appears. Do not put blood on top of the test strip.

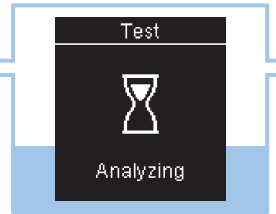

The test result appears on the display in less than 4 seconds.

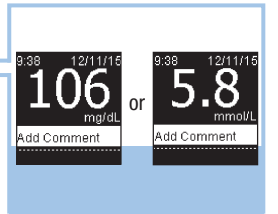

The test result appears on the display in less than 4 seconds.



Prepare the lancing device for the next test. Slide the lever over and back once to advance to the next lancet. The window shows the number of lancets remaining.

### Download the free Accu-Chek Connect diabetes management app\* at:



\*Available for select mobile devices.

LAST UPDATE: 2015-09

Roche Diabetes Care GmbH  
Sandhofer Strasse 116  
68305 Mannheim, Germany  
www.accu-chek.com



ACCU-CHEK, ACCU-CHEK CONNECT, ACCU-CHEK GUIDE, and FASTCLIX are trademarks of Roche.

APPLE, APPLE logo, and APP STORE are trademarks of Apple Inc.

GOOGLE PLAY is a trademark of Google Inc.

© 2016 Roche Diabetes Care  
07791267001-0116  
07791267001(01)-0116



- Roche USA – 54080  
V4/1 – 07791267001  
07791267001(01) – Black
- Roche USA – 54080  
V4/2 – 07791267001  
07791267001(01) – Cyan
- Roche USA – 54080  
V4/3 – 07791267001  
07791267001(01) – Magenta
- Roche USA – 54080  
V4/4 – 07791267001  
07791267001(01) – Yellow

# 由此開始

## 快速入門指南

### 警告

- 本快速入門指南並不能取代您的 Accu-Chek Guide 血糖機使用者手冊。使用者手冊內有重要操作指示以及其他資訊。
- 採血筆僅供個人使用。

### 概觀



- 1 螢幕
- 2 返回鍵
- 3 向上鍵和向下鍵
- 4 開關/設定/「OK」鍵
- 5 帶有指示燈的試紙槽
- 6 電池蓋
- 7 Micro USB 連接埠
- 8 試紙退出鍵

### 設定語言和時間格式



按一下 **開** 開啟血糖機。螢幕出現 **Language** (語言) 選項。按 **左** 或 **右**，選擇所需語言。然後按 **開**。

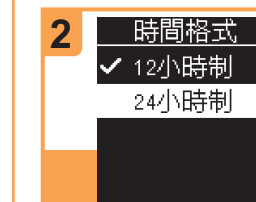

螢幕出現 **時間格式** 選項。按 **左** 或 **右** 選擇 **12小時制** (am/pm, 即上午/下午) 或 **24小時制**。按 **開** 確定選項，並返回 **主選單**。

### 準備採血筆



熟悉 Accu-Chek FastClix 易極採血筆。

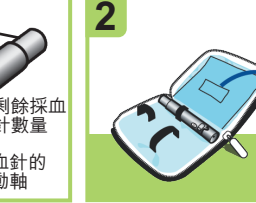

從攜帶包的內袋取出一個新的滾筒式針筒。

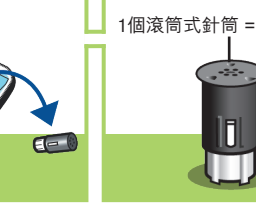

拉開採血筆筆蓋。請勿扭轉採血筆筆蓋。



將滾筒式針筒 (白色端向內) 放入採血筆。將針筒推到底，直到穩當扣住。

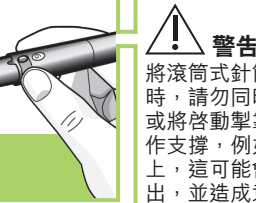

調校採血深度至舒適的度數。由「2」開始，較厚的皮膚可調校至較大的度數。

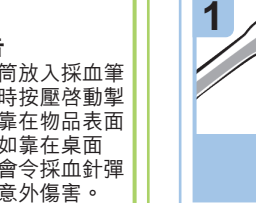

使用採血筆：按下採血筆啟動掣，一按即就完成上針和採血。

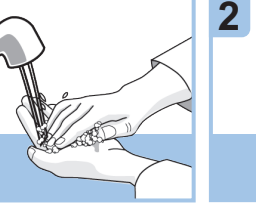

準備好進行檢測...

### 執行血糖檢測

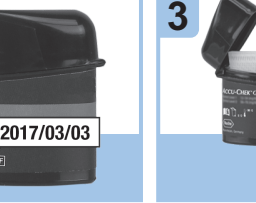

檢測前請洗淨並抹乾您的雙手。



檢查試紙瓶上的保存期限。請勿使用過期的試紙。

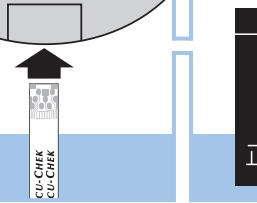

從試紙瓶取出一片新試紙。然後蓋緊瓶蓋。



將試紙的金屬端插入血糖機中。

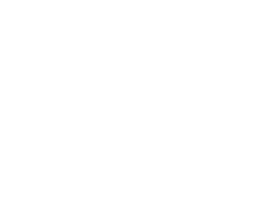

血糖機開啟。顯示正在準備檢測。

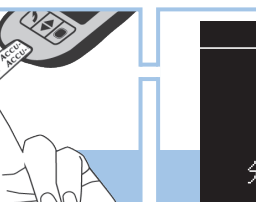

將採血筆緊貼您指尖的一側，按下啟動掣從指尖採血。

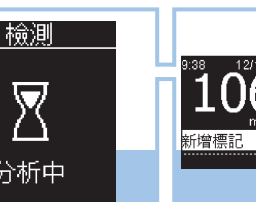

將血滴沾到試紙的黃色邊緣。螢幕出現 **分析中** 時，將手從試紙拿開。請勿將血滴放在試紙上方。

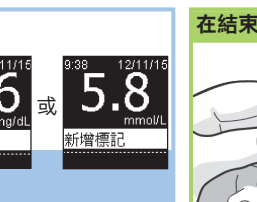

檢測值會在 4 秒內顯示在螢幕上。



為下次檢測準備好採血筆。來回推一下白色轉動軸，便可使用下一支新的採血針。小窗口數字顯示剩餘採血針數量。

下載免費的 Accu-Chek Connect 糖尿病管理應用程式\*：



\*適用於指定行動裝置。

最近更新日期：2015-09

Roche Diabetes Care GmbH  
Sandhofer Strasse 116  
68305 Mannheim, Germany  
www.accu-chek.com



Accu-Chek、Accu-Chek Connect、Accu-Chek Guide 和 FastClix 是 Roche (羅氏) 的商標。

Apple、Apple 標誌和 App Store 是 Apple Inc. 的商標。  
Google Play 是 Google Inc. 的商標。

© 2016 Roche Diabetes Care  
07791267001-0116  
07791267001(01)-0116

