

Observera! Denna förkortade snabbguiden ersätter inte produktens bruksanvisning.

## Setting up the Lancing Device

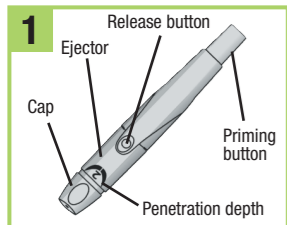

Familiarize yourself with the Accu-Chek Softclix lancing device.



Get a lancet from the pocket in the carry case.

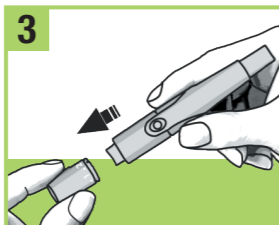

Remove the cap by pulling it straight off. Do not twist the cap.

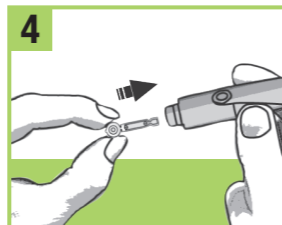

Insert the lancet into the lancing device until it clicks.

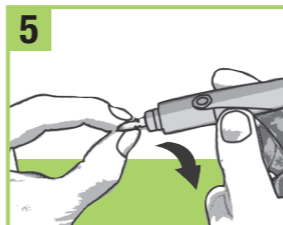

Twist off the lancet's protective cap.

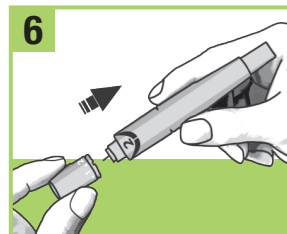

Replace the cap on the lancing device. Make sure the notch on the cap lines up with the notch on the lancing device.



Adjust the lancet depth to a comfortable penetration level. Start at 2. For tougher skin, dial a higher number.

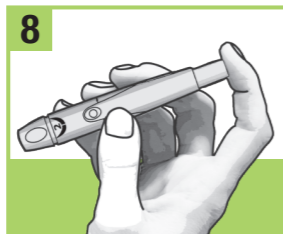

Press the priming button in as far as it will go, like a pen. Do not press the release button while pressing the priming button. The release button turns yellow when the lancing device is ready.



Set the lancing device aside until you are ready to perform a fingerstick.

## Performing a Blood Glucose Test

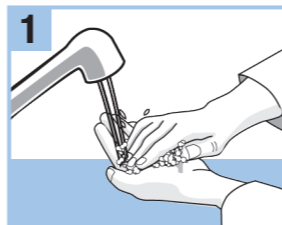

Wash your hands with warm soapy water and dry thoroughly.

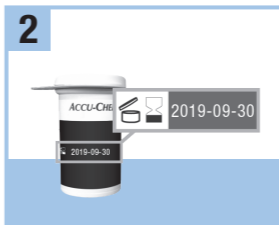

Check the use by date on the test strip container. Do not use test strips past the use by date.



Remove a test strip from the test strip container. Close the cap tightly.

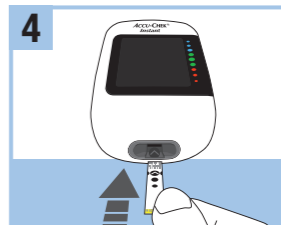

Insert the metallic end of the test strip into the meter. The meter turns on.

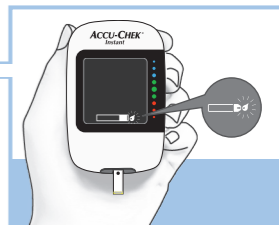

A flashing drop symbol appears.



Press the lancing device firmly against the side of your fingertip and press the yellow release button to prick your finger.

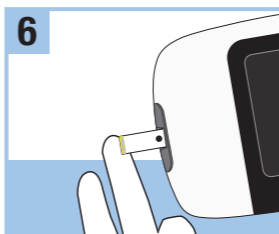

Touch the **yellow edge** of the test strip to the blood drop. Remove your finger from the test strip when the flashing hourglass symbol appears. Do not put blood on top of the test strip.

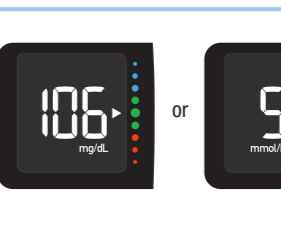
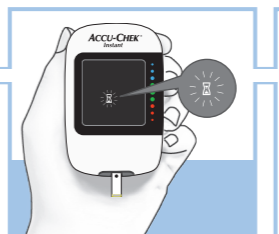

The test result appears on the display in less than 4 seconds.



Remove the lancing device cap. Point the lancet away from you. Slide out the ejector to release the lancet.